

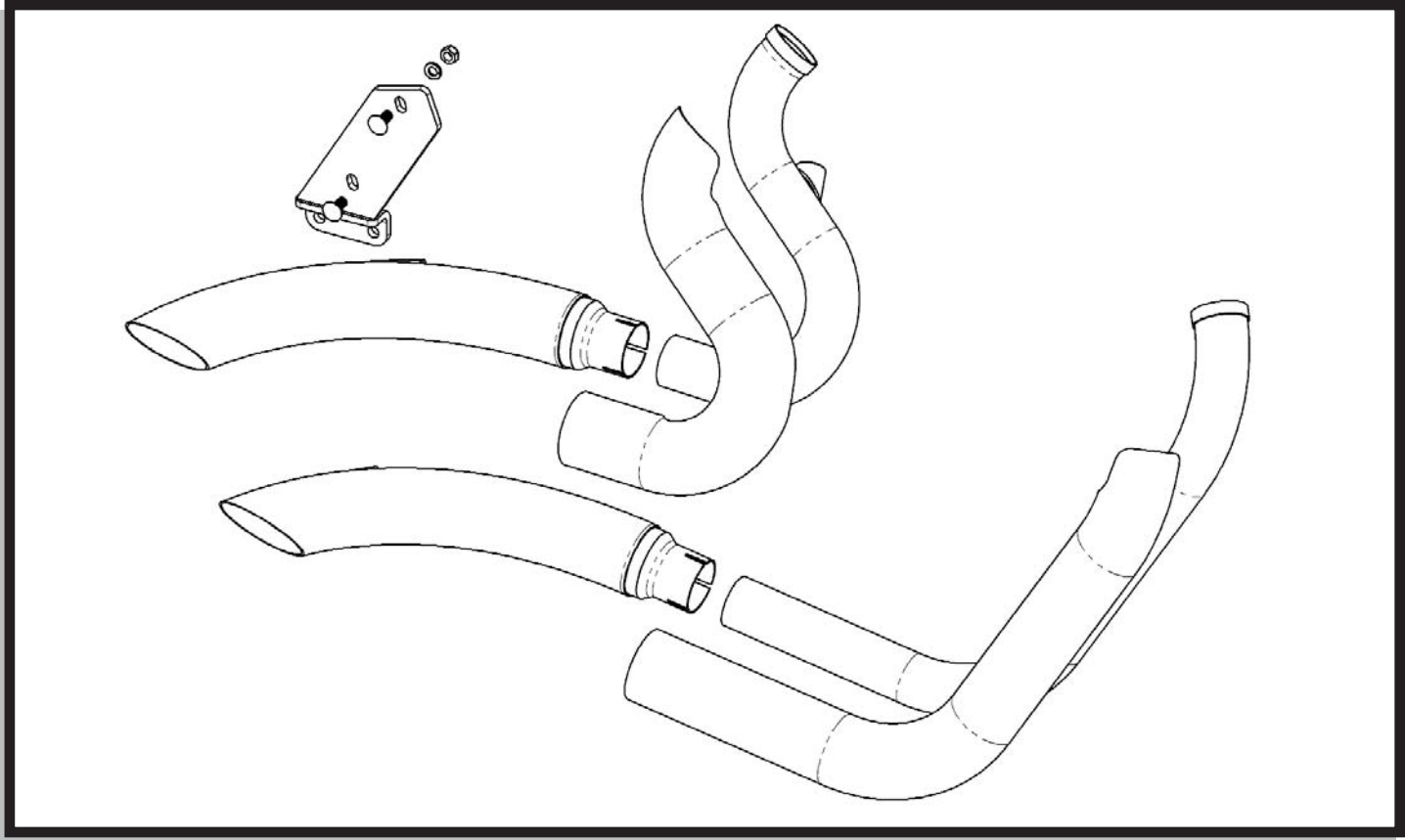

RCX205C / RCX205B

FULL RADIUS EXHAUST, CHROME / BLACK

**H-D SOFTAIL
1986-2011**



PARTS INCLUDED

Ref.	Part Number	Description	Qty
1)	00-300-02349	Front Headpipe Assembly	1
2)	00-300-02350	Rear Headpipe Assembly	1
3)	00-300-02351	Front Headpipe Heat Shield, Chrome	1
4)	00-300-02352	Rear Headpipe Heat Shield, Chrome	1
5)	00-300-02355	Top Radius Muffler Assembly, Chrome	1
6)	00-300-02354	Bottom Radius Muffler Assembly, Chrome	1
7)	00-300-02359	Muffler Mounting Bracket	1
8)	01-12061618-27	Socket Head Cap Screw, 3/8-16x2-1/4"	1
9)	01-13051806-27	Carriage Bolt, 5/16-18x3/4"	2
10)	01-4205-27	Lock Washer, 5/16"	2
11)	01-300518-27	Nylock Hex Nut, 5/16-18	2
12)	07-38-28HC	Hose Clamp, #28	5
13)	01-6418150-20	O2 Sensor Plug, M18-1.50	2

08-50-47110 REV. B



373 Mitch McConnell Way • Bowling Green, Kentucky 42101 • 1-800-360-0915
 fax: 270-842-9527 • email: rcc@rccomponents.com
www.rccomponents.com

RCX205C

FULL RADIUS EXHAUST, CHROME

**H-D SOFTAIL
1986-2011**

NOTE

RCX exhaust systems may not meet EPA and/or carb emissions in the State of California or other States with similar emission control restrictions. End user of product shall determine acceptable use in compliance with local and federal laws. User of product assumes all risk and financial obligations in violation of such regulations as a result of vehicle inspections or emission tests.

INSTALLATION INSTRUCTIONS

- 1) Make sure the motorcycle is cool and place securely on a service lift or center stand.
- 2) Loosen completely the clamps securing the stock heat shields to the front and rear headpipes. Remove the heat shields from the headpipes.
- 3) Loosen the clamps securing the stock mufflers to the head pipes.
- 4) Remove the 2 bolts securing the top muffler to the muffler mounting bracket. Remove the top muffler.
- 5) Remove the 4 bolts securing the bottom muffler to the muffler mounting bracket. Remove the bottom muffler.
- 6) **O2 sensor equipped models only:** Locate the rear O2 sensor connector under the oil tank, on the right hand side. Unplug the connector and feed the wire through the frame to allow removal from the motorcycle. *NOTE: Make note of wire routing for reinstallation.*
- 7) **O2 sensor equipped models only:** Locate the front O2 sensor connector under the plastic cover above the rectifier mounted to the front of the motorcycle frame. Unplug the connector and feed the wire through the frame to allow removal from the motorcycle. *NOTE: Make note of wire routing for reinstallation.*
- 8) Remove the two rear headpipe flange mounting nuts. Remove the rear headpipe.
- 9) Remove the two front headpipe flange mounting nuts. Remove the front headpipe.
- 10) **FLSTN, FLSTF, FXSTD models only:** The passenger footpeg must be removed in order to remove the stock muffler mounting bracket. Remove the passenger footpeg pin, and footpeg. Remove the passenger footpeg mounting bracket.
- 11) Remove the nuts securing the stock muffler mounting bracket to the motorcycle frame. Remove the muffler mounting bracket.
- 12) Carefully remove the O2 sensors from the stock front and rear headpipes.



373 Mitch McConnell Way • Bowling Green, Kentucky 42101 • 1-800-360-0915
fax: 270-842-9527 • email: rcc@rccomponents.com

www.rccomponents.com

RCX205C

FULL RADIUS EXHAUST, CHROME

H-D SOFTAIL
1986-2011

INSTALLATION INSTRUCTIONS

- 13) Using snapping pliers, carefully remove the headpipe flanges, and circlips, from the stock headpipes. *NOTE: Replace circlips if they are bent or damaged during removal.*
- 14) Inspect exhaust port gaskets, and replace if necessary.
- 15) Using the original nuts, mount the supplied muffler mounting bracket to the motorcycle frame. When mounted, the bracket should "pointing" forward, with the offset facing outward. Snug the nuts, but do not fully tighten at this time. (Fig. 1)
- 16) Apply a small amount of thread sealant to the thread of the O2 sensors, and install the O2 sensors into the locations in the new headpipes. *NOTE: Make sure no thread sealant gets onto the sensor portion of the O2 sensors.*
- 17) Install the original headpipe flanges and circlips to the new headpipes.
- 18) Using the original nuts, loosely install the new front and rear headpipes to the motor. Snug the nuts, but do not fully tighten at this time.
- 19) Loosely place one original muffler inlet clamp onto the inlet of the new top radius muffler. Locate one supplied 5/16-18x3/4" carriage bolt, one 5/16" lock washer, and one 5/16-18 hex nylock nut. Slide the top radius muffler onto the rear headpipe outlet. Secure the muffler to the upper hole on the muffler mounting bracket using the located hardware. Do not fully tighten at this time. (Fig. 2)
- 20) Loosely place the remaining original muffler inlet clamp onto the inlet of the new bottom radius muffler. Locate the remaining supplied 5/16-18x3/4" carriage bolt, 5/16" lock washer, and 5/16-18 hex nylock nut. Slide the bottom radius muffler onto the front headpipe outlet. Secure the muffler to the lower hole on the muffler mounting bracket using the located hardware. Do not fully tighten at this time.

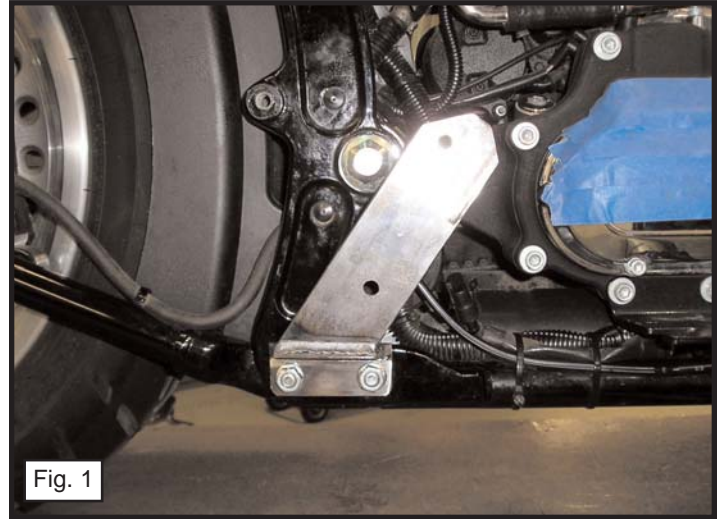

373 Mitch McConnell Way • Bowling Green, Kentucky 42101 • 1-800-360-0915
fax: 270-842-9527 • email: rcc@rccomponents.com

www.rccomponents.com

RCX205C

FULL RADIUS EXHAUST, CHROME

H-D SOFTAIL
1986-2011

INSTALLATION INSTRUCTIONS

- 21) Feed one provided hose clamp into each mounting bracket on the inside of the rear headpipe heat shield. Carefully place the heat shield over the rear headpipe and start tightening the hose clamps, but leave loose for now.
- 22) Feed one provided hose clamp into each mounting bracket on the inside of the front headpipe heat shield. Carefully place the heat shield over the front headpipe and start tightening the hose clamps, but leave loose for now.
- 
- 23) Position the heat shields on the head pipes so that they best match the head pipes. Slide the muffler on the head pipes until they are flush with the heat shields. (Fig. 3)
- 24) Position the exhaust system so that all components are in their best possible location, and all gaps between the mufflers are even. Fully tighten the muffler bracket mounting nuts, and the muffler mounting bolts.
- 25) Fully tighten the headpipe flange nuts. Fully tighten the muffler inlet clamps. Fully tighten the heat shield clamps.
- 26) Feed the front and rear O2 sensor wire through the frame in the original location. Reconnect the O2 sensor plugs. Reattach the plastic cover on the front of the motorcycle frame.
- 27) **FLSTN, FLSTF, FXSTD models only:** Reinstall the right side passenger footpeg mounting bracket to the motorcycle frame, using the supplied 3/8-16x2-1/4" socket head bolt. Torque bolt to factory specification. Reinstall passenger footpeg to mount.
- 28) Re-check all applicable hardware and torque to factory specification if needed.
- 29) Using warm soapy water and a soft towel, clean all fingerprints and grease from the exhaust system. Failure to do so can cause damage to the exhaust system once hot.



373 Mitch McConnell Way • Bowling Green, Kentucky 42101 • 1-800-360-0915
fax: 270-842-9527 • email: rcc@rccomponents.com

www.rccomponents.com